

## ENGINE

Model	Case Family III 445/M2 diesel, Tier II certified
Type	4-stroke, naturally aspirated
Cylinders	4
Bore/Stroke	4.09 in x 5.19 in (104 x 132 mm)
Displacement	272 in <sup>3</sup> (4.5 L)
Fuel injection	Direct
Fuel	Diesel
Fuel filter	w/water trap
Air intake	Cross-flow
Cooling	Liquid
Engine speeds* (rpm)	
Rated speed, full load	2200
Low idle	750 - 850
High idle, no load	2380 - 2480
Horsepower	
Gross	80 (60 kW) @ 2200 rpm
Net	76 (57 kW) @ 2200 rpm
Maximum torque @ 1400 rpm	
Gross	236 lb-ft (320 N-m)
Net	231 lb-ft (314 N-m)
Torque rise at rated speed	23%

NOTE: Meets federal emission regulations.

## ENGINE COOLING

Radiator	
Core type	Square wave
Core size area	487 in <sup>2</sup> (.315 m <sup>2</sup> )
Rows of tubes	4
Fan	
Style	7 blade suction
Diameter	19.2 in (488 mm)
Ratio	1.1:1
Water pump	
Style	Integral
Engine oil	
Pump	Deep sump plate cooler with pressurized under-piston nozzles
Pump operating angle ratings	
Side-to-side	Rated 35°
Fore and aft	Rated 35°
Oil filtration	Replaceable, full-flow cartridge

## TIRES

Front	
2WD	11L x 16.1, 10-ply rating
4WD	12 x 16.5, 8-ply rating
Rear	
2/4WD	17.5L x 24, 10-ply rating
2/4WD	19.5L x 24, 10-ply rating

## POWERTRAIN

Transmission	4-speed synchromesh with hydraulically actuated clutches and electric F/R shuttle control, clutch disconnect buttons on the transmission shifter and loader control lever		
Gear ratios	Forward	Reverse	
1st	5.491	4.550	
2nd	3.043	2.522	
3rd	1.584	1.313	
4th	0.793	0.657	
Torque converter			
Ratio	3.337		
Differential lock	On-the-go push-button activation		
Front axle			
Differential ratio	2.0		
Planetary hub ratio	6.0		
Total reduction ratio	12.0		
Rear axle			
Differential ratio	2.333		
Planetary hub ratio	6.923		
Total reduction ratio	16.153		

### Service brakes

Individually applied, hydraulically actuated, maintenance-free, self-adjusting, inboard mounted, wet disc

Disc area 53 in<sup>2</sup> (.03 m<sup>2</sup>)

### Parking brakes

Mechanically applied with electric activation sensors at each brake

### Travel speeds – mph (km/h)

	1st	2nd	3rd	4th
Forward	3.5 (5.7)	6.4 (10.3)	12.3 (19.7)	24.5 (39.4)
Reverse	4.3 (6.9)	7.7 (12.4)	14.8 (23.8)	29.6 (47.6)

NOTE: Travel speeds at 2288 engine rpm with 19.5 x 24 tires. Speeds decrease with 17.5L x 24 rear tires.

## ELECTRICAL

Voltage	12 volts, negative ground
Alternator	90 amp
Battery	850 cold-cranking amps
Optional batteries	(2) 600 cold-cranking amps
Power plugs	(2) 30 amps ea.

## HYDRAULICS

Pump	Gear-type, transmission driven
Main relief pressure	3050 + 50 - 50 psi @ 28.5 gpm (210 + 3 - 3 bar @ 108 L/min)
Filtration	7-micron, full flow replaceable cartridge on return line, condition indicator light for filter
Oil cooler	Heavy-duty
Loader flow @ rated engine rpm	28.5 gpm @ 3050 psi (108L/min @ 210 bar)
Loader control valve	Monoblock single lever control for lift, tilt and auxiliary hydraulics, positive hold float and return-to-dig
Loader auxiliary hydraulics with full loader flow available	
Backhoe flow @ rated engine rpm	28.5 gpm @ 3050 psi (108 L/min @ 210 bar)

### Manual Backhoe Controls

#### Backhoe Control Valve

Monoblock open-center, parallel circuits.  
Boom and dipper, with pilot operated checks

### Pilot Backhoe Controls

#### Backhoe Control Valve

Sectional closed-center with inlet compensator and circuits in parallel

### Backhoe auxiliary hydraulics

Uni-directional flow, adjustable variable flow from 0 to 28.5 gpm (108 L/min)

#### Control operation

Manual Foot switch activated  
Pilot Button on left joystick

Bi-Directional flow, variable flow from 0 to 28.5 gpm (108 L/min) @ rated engine rpm

#### Control Operation

Manual Hand lever  
Pilot Buttons on left joystick

## OPERATOR ENVIRONMENT

ROPS/FOPS canopy
Key start
Hydrostatic steering
Non-suspension seat w/180° swivel
Hand and foot throttles
Loader control lever w/push-button activation of differential lock and transmission de-clutch
Backhoe foot-swing w/3 lever control
(2) Accessory power plugs (30 amp)
Anti-vandalism covers (canopy only)
Cup holder
Coat hook w/tether strap (cab only)
Interior rearview mirror
2 in (51 mm) retractable seat belt
Storage compartment w/lid
Left side storage tray

## INSTRUMENTATION

Gauges
Engine water temperature
Converter oil temperature
Fuel
Tachometer/hourmeter
Voltmeter
Warning lights
Air cleaner restriction
Alternator
Engine oil pressure
Hydraulic oil filter bypass
Parking brake engagement
Rear axle fluid temperature sensing system
Low fuel
Audible alarms
Coolant temperature
Engine oil pressure
Parking brake engagement
Shuttle engagement/seat position
Backup alarm
Turn signal indicators
Horn

## TURNING DIAMETER

2WD	
Brakes on	21 ft 3 in (6.48 m)
Brakes off	24 ft 7 in (7.49 m)
4WD – engaged	
Brakes on	22 ft 1 in (6.72 m)
Brakes off	28 ft 3 in (8.62 m)
4WD – disengaged	
Brakes on	22 ft 0 in (6.70 m)
Brakes off	25 ft 3 in (7.70 m)

NOTE: Turning diameter dimensions curb to curb w/19.5L x 24 rear tires and 82 (2.08 m) general purpose or 4 in 1 bucket..

## OPERATING WEIGHTS

### Lightest Configuration

Unit equipped with 2WD, ROPS canopy, non-suspension seat, 82 in (2.08 m) general purpose loader bucket, 24 in (610 mm) general purpose backhoe bucket, standard dipperstick, 17.5L x 24 rear tires, 11L x 16.1 front tires, single battery, standard cast stabilizer pads, no operator 13,359 lb (6060 kg)

### Heaviest Configuration

Unit equipped with 4WD, cab, suspension seat, 82 in (2.08 m) 4 IN 1® loader bucket, 24 in (610 mm) general purpose backhoe bucket, Extendahoe® dipperstick, 19.5L x 24 rear tires, 12L x 16.5 front tires, dual batteries, flip stabilizer pads, no operator 16,510 lb (7489 kg)

### Add-on weights

Cab (over canopy)	+454 lb (206 kg)
Counterweights	+440 lb (200 kg) +900 lb (408 kg)
Extendahoe®	+430 lb (195kg)
4WD w/driveshaft guard	+283 lb (128 kg)

## SERVICE CAPACITIES

Fuel tank	31.4 gal (119 L)
Optional tank	40 gal (151 L)
Hydraulic system	
Total	28.0 gal (106 L)
Total w/Extendahoe®	29.5 gal (111.7 L)
Reservoir w/filter	14.5 gal (54.9 L)
Reservoir w/o filter	14.0 gal (53 L)
Transmission	
2WD Total system	19.5 qt (18.5 L)
4WD Total system	22.0 qt (20.8 L)
4WD Front axle	
Differential	5.8 qt (5.5 L)
Planetaries (each)	0.7 qt (0.66 L)
Rear axle	
Differential	15.0 qt (14.2 L)
Planetaries (each)	1.6 qt (1.5 L)
Engine oil w/filter	14.4 qt (13.6 L)
Cooling system	
w/heater	17.8 qt (16.8 L)
w/o heater	17.0 qt (16.1 L)
Window washer reservoir	2.5 qt (2.36 L)

## LOADER

Single-lever control for lift and tilt
Positive hold float
Return-to-dig
Automatic self-leveling
In-line, reverse linkage
Dual parallel dump cylinders
Clutch disconnect button on loader control and shift levers
Bucket position indicator

### Loader Bucket Sizes

Width	Weight	Struck	Heaped
General Purpose Bucket			
82 in (2.08 m)	686 lb* (311 kg)	0.87 yd³ (0.67 m³)	1.03 yd³ (0.79 m³)
93 in (2.36 m)	933 lb* (423 kg)	1.07 yd³ (0.82 m³)	1.25 yd³ (0.96 m³)
4 IN 1® Bucket			
82 in (2.08 m)	1462 lb (663 kg)	0.85 yd³ (0.65 m³)	1.04 yd³ (0.80 m³)

NOTE: \*Add 103 lb (47 kg) to 82 in (2.08 m) general purpose bucket for bolt-on cutting edge.

## BACKHOE

Over-center design
Cast, ductile iron boom, and swing tower
Open-center hydraulics - Pro Control System
15, 700 lb-ft (21 297 N-m) swing torque
Foot-swing w/3 lever control
Wing stabilizers w/cleated dirt pad

### Backhoe Bucket Sizes

Width	Weight	Heaped
General Purpose Trenching Buckets		
18 in (457 mm)	255 lb (116 kg)	4.7 ft³ (0.13 m³)
24 in (610 mm)	300 lb (136 kg)	6.26 ft³ (0.17 m³)
30 in (762 mm)	380 lb (172 kg)	7.83 ft³ (0.22 m³)
Universal Buckets		
12 in (305 mm)	290 lb (132 kg)	3.40 ft³ (0.10 m³)
16 in (406 mm)	346 lb (157 kg)	3.60 ft³ (0.10 m³)
18 in (457 mm)	350 lb (159 kg)	5.30 ft³ (0.15 m³)
24 in (610 mm)	413 lb (187 kg)	7.70 ft³ (0.22 m³)
30 in (762 mm)	475 lb (215 kg)	10.20 ft³ (0.29 m³)
36 in (914 mm)	535 lb (243 kg)	12.70 ft³ (0.36 m³)
High Capacity Buckets		
24 in (610 mm)	450 lb (204 kg)	8.50 ft³ (0.24 m³)

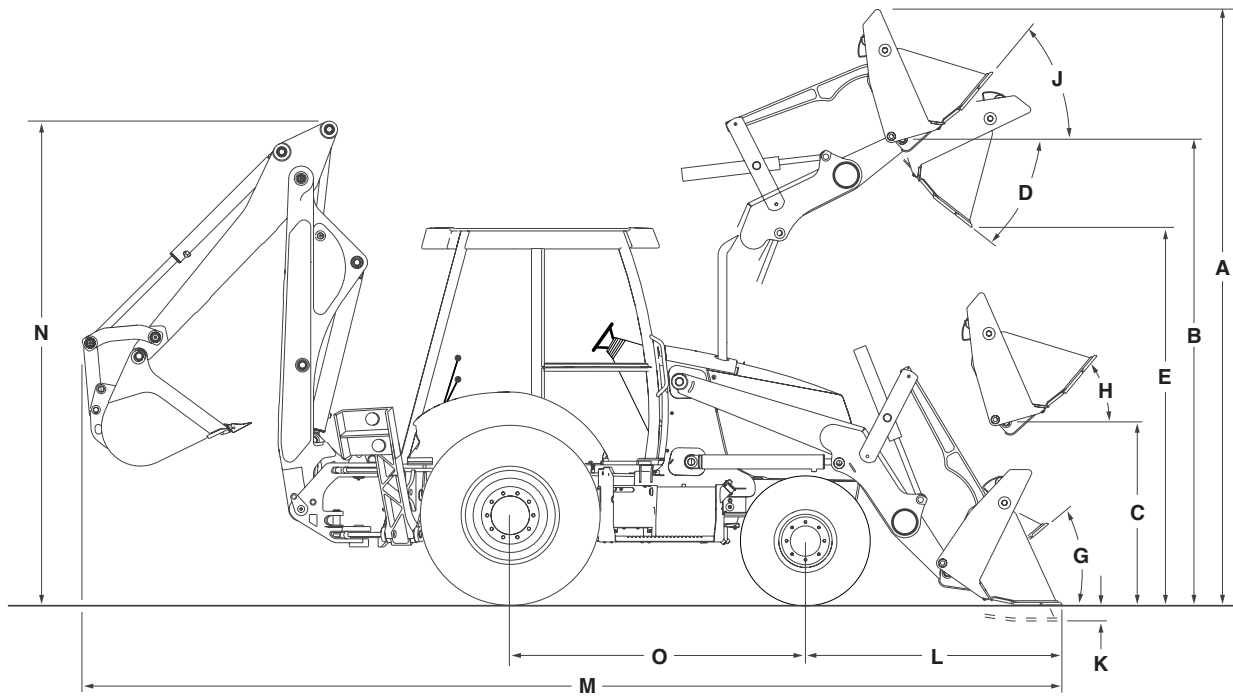

## LOADER DIMENSIONS

	General Purpose Bucket*	4 IN 1® Bucket
<b>A.</b> Overall operating height – fully raised	13 ft 8 in (4.17 m)	14 ft 3 in (4.34 m)
Height to –		
<b>B.</b> Bucket hinge pin fully raised	11 ft 2 in (3.4 m)	11 ft 2 in (3.4 m)
<b>C.</b> Bucket hinge pin @ SAE carry	12.7 in (323 mm)	14.6 in (372 mm)
<b>D.</b> Dump angle @ full height	46°	45°
<b>E.</b> Dump clearance @ full height, 45° dump –		
Bucket	8 ft 8 in (2.64 m)	8 ft 11 in (2.72 m)
Clam open	NA	9 ft 8 in (2.95 m)
<b>F.</b> Dump reach @ full height, 45° dump –		
Bucket	28.2 in (717 mm)	27.7 in (704 mm)
Clam open	NA	14.2 in (360 mm)
Bucket rollback –		
<b>G.</b> @ groundline	40°	40°
<b>H.</b> @ SAE carry	45°	45°
<b>J.</b> @ full height	Adjustable	Adjustable
<b>K.</b> Digging depth below grade –		
Bucket flat	7.8 in (199 mm)	7.1 in (180 mm)
Clam open (dozing)	NA	4.4 in (111 mm)
<b>L.</b> Reach from front axle centerline – bucket on ground	77.6 in (1.91 m)	75.2 in (1.85 m)
Lift capacity to full height	6,182 lb (2804 kg)	5,514 lb (2501 kg)
Breakout force –		
Lift cylinders	9,164 lbf (40 760 N)	8,766 lbf (39 600 N)
Dump cylinders	9,480 lbf (42 170 N)	10,325 lbf (45 820 N)
Bucket cutting edge width	82 in (2.08 m)/93 in (2.36 m)	82 in (2.08 m)
Maximum grading angle	116°	116°
Maximum clam opening	NA	38.3 in (972 mm)
Moldboard height	NA	36.8 in (934 mm)
Raising time to full height	5.3 sec	5.3 sec
Bucket dumping time	1.1 sec	1.1 sec
Lowering time –		
Power down	2.4 sec	2.4 sec
Return-to-dig	3.2 sec	3.2 sec
Clam –		
Open time	NA	2.3 sec
Close time	NA	3.1 sec

NOTE: Loader dimensions taken with 4WD, 19.5L x 24 rear tires and 82 in (2.08 m) general purpose bucket \*without bolt-on cutting edge.

## DIMENSIONS

	Standard Backhoe	Extendahoe®	
		Retracted	Extended
<b>M.</b> Overall transport length –			
General purpose bucket	23 ft 2 in (7.07 m)	23 ft 2 in (7.07 m)	NA
4 IN 1® bucket	23 ft 1 in (7.05 m)	23 ft 1 in (7.05 m)	NA
Overall transport width	7 ft 2 in (2.18 m)	7 ft 2 in (2.18 m)	NA
Height –			
To top of canopy	8 ft 9 in (2.67 m)	8 ft 9 in (2.67 m)	8 ft 9 in (2.67 m)
To top of cab	8 ft 11 in (2.72 m)	8 ft 11 in (2.72 m)	8 ft 11 in (2.72 m)
To top of exhaust stack	8 ft 8 in (2.64 m)	8 ft 8 in (2.64 m)	8 ft 8 in (2.64 m)
<b>N.</b> Transport	11 ft 3 in (3.42 m)	11 ft 7 in (3.53 m)	11 ft 7 in (3.53 m)
Ground clearance at backhoe frame	14.8 in (376 mm)	14.8 in (376 mm)	14.8 in (376 mm)
Angle of departure	20°	20°	20°
Front wheel tread –			
2WD	67.5 in (1.71 m)	67.5 in (1.71 m)	67.5 in (1.71 m)
4WD	67.7 in (1.72 m)	67.7 in (1.72 m)	67.7 in (1.72 m)
Width across tires			
17.5L x 24	81.7 in (2.074 m)	81.7 in (2.074 m)	81.7 in (2.074 m)
19.5L x 24	81.4 in (2.67 m)	81.4 in (2.67 m)	81.4 in (2.67 m)
<b>O.</b> Wheelbase –			
2WD	84 in (2.13 m)	84 in (2.13 m)	84 in (2.13 m)
4WD	84.5 in (2.15 m)	84.5 in (2.15 m)	84.5 in (2.15 m)

## CYLINDERS

	Bore Diameter	Rod Diameter	Stroke
<b>Loader</b>			
Lift (2)	3.25 in (82.6 mm)	1.75 in (44.5 mm)	30.2 in (766 mm)
Bucket (2)	2.75 in (69.9 mm)	1.5 in (38.1 mm)	20.6 in (522 mm)
4 IN 1® clam (2)	3.0 in (76 mm)	1.75 in (44.5 mm)	9.1 in (231 mm)
<b>Backhoe</b>			
Boom	4.5 in (114 mm)	2.25 in (57.2 mm)	38.6 in (981 mm)
Dipperstick	4.25 in (108 mm)	2.25 in (57.2 mm)	27.0 in (686 mm)
Bucket	3.25 in (82.6 mm)	2.25 in (57.2 mm)	34.3 in (872 mm)
Extendahoe®	3.0 in (76 mm)	1.75 in (44.5 mm)	42.0 in (1.07 m)
Swing (2)	3.75 in (95.3 mm)	2.0 in (50.8 mm)	11.5 in (292 mm)
Stabilizer (2)	4.0 in (101.6 mm)	2.0 in (50.8 mm)	21.8 in (553 mm)
<b>Steering</b>			
2WD	2.75 in (69.9 mm)	1.5 in (38.1 mm)	6.7 in (170 mm)
4WD	2.48 in (63 mm)	1.5 in (38.1 mm)	9.53 in (242 mm)

## BACKHOE LIFT CAPACITIES

Boom Lift	Standard Backhoe		Extendahoe®			
	Distance from swing pivot (m)	Backhoe lift capacity – lb (kg)	Retracted		Extended	
			Distance from swing pivot (m)	Backhoe lift capacity – lb (kg)	Distance from swing pivot (m)	Backhoe lift capacity – lb (kg)
+16 ft (4.87 m)					12 ft 7 in (3.84)	810 (367)
+14 ft (4.27 m)	8 ft 3 in (2.52)	1,950 (885)	9 ft 6 in (2.89)	1,280 (581)	14 ft 8 in (4.47)	1,400 (635)
+12 ft (3.66 m)	10 ft 9 in (3.28)	2,700 (1225)	11 ft 10 in (3.61)	1,940 (880)	16 ft 2 in (4.93)	1,430 (649)
+10 ft (3.05 m)	12 ft 7 in (3.84)	2,700 (1225)	13 ft 5 in (4.09)	2,200 (998)	17 ft 3 in (5.26)	1,540 (699)
+8 ft (2.44 m)	13 ft 6 in (4.11)	2,750 (1247)	14 ft 7 in (4.45)	2,220 (1007)	18 ft 1 in (5.52)	1,610 (730)
+6 ft (1.83 m)	14 ft 5 in (4.40)	2,730 (1238)	15 ft 3 in (4.65)	2,260 (1025)	18 ft 8 in (5.69)	1,620 (735)
+4 ft (1.22 m)	14 ft 9 in (4.50)	2,720 (1234)	15 ft 10 in (4.82)	2,290 (1039)	19 ft 0 in (5.79)	1,660 (753)
+2 ft (0.61 m)	14 ft 11 in (4.55)	2,680 (1216)	16 ft 0 in (4.88)	2,290 (1039)	19 ft 1 in (5.82)	1,700 (771)
<b>Ground Level</b>	14 ft 8 in (4.47)	2,490 (1129)	15 ft 11 in (4.85)	2,270 (1030)	18 ft 10 in (5.74)	1,730 (785)
-2 ft (0.61 m)	14 ft 3 in (4.35)	2,440 (1107)	15 ft 7 in (4.75)	2,260 (1025)	18 ft 6 in (5.64)	1,720 (780)
-4 ft (1.22 m)	13 ft 4 in (4.06)	2,440 (1107)	14 ft 10 in (4.52)	2,240 (1016)	17 ft 10 in (5.43)	1,730 (785)
-6 ft (1.83 m)	12 ft 0 in (3.66)	2,440 (1107)	13 ft 10 in (4.21)	2,270 (1030)	17 ft 0 in (5.18)	1,740 (789)
-8 ft (2.44 m)	10 ft 2 in (3.10)	2,500 (1134)	12 ft 6 in (3.81)	2,350 (1066)	15 ft 9 in (4.80)	1,780 (807)
-10 ft (3.05 m)	7 ft 0 in (2.13)	2,780 (1261)	10 ft 4 in (3.15)	2,350 (1066)	14 ft 1 in (4.30)	1,870 (848)
-12 ft (3.66 m)					11 ft 9 in (3.58)	2,040 (925)
-14 ft (4.27 m)					8 ft 1 in (2.47)	2,610 (1184)

### Dipper Lift

+14 ft (4.27 m)					13 ft 4 in (4.06)	2,120 (962)
+12 ft (3.66 m)	9 ft 9 in (2.97)	3,950 (1792)	10 ft 8 in (3.25)	3,430 (1556)	14 ft 2 in (4.32)	2,210 (1002)
+10 ft (3.05 m)	10 ft 4 in (3.15)	3,690 (1674)	11 ft 1 in (3.38)	3,170 (1438)	14 ft 6 in (4.42)	2,200 (998)
+8 ft (2.44 m)	10 ft 2 in (3.10)	3,750 (1701)	11 ft 0 in (3.35)	3,240 (1470)	14 ft 5 in (4.40)	2,160 (980)
+6 ft (1.83 m)	9 ft 4 in (2.84)	4,100 (1860)	10 ft 2 in (3.10)	3,610 (1637)	13 ft 10 in (4.21)	2,230 (1012)
+4 ft (1.22 m)	7 ft 6 in (2.29)	4,710 (2136)	8 ft 2 in (2.49)	4,290 (1946)	12 ft 10 in (3.91)	2,420 (1098)

NOTE: Stated figures apply straight to the rear of prime mover. Equipped with 24 in (610 mm) general purpose trenching bucket and links. For heavy-duty universal bucket and coupler, deduct 175 lb (79 kg) from each weight.

## BACKHOE OPERATIONAL DATA

	Standard Backhoe		Extendahoe®	
			Retracted	Extended
Digging depth –				
Maximum	14 ft 3 in (4.34 m)		14 ft 10 in (4.52 m)	18 ft 3 in (5.56 m)
2 ft (610 mm) flat bottom	14 ft 2 in (4.32 m)		14 ft 8 in (4.47 m)	18 ft 2 in (5.54 m)
8 ft (2.44 m) flat bottom	13 ft 3 in (4.04 m)		13 ft 9 in (4.19 m)	17 ft 6 in (5.33 m)
Overall reach from –				
Rear axle centerline	21 ft 5 in (6.53 m)		22 ft 0 in (6.70 m)	25 ft 5 in (7.75 m)
Swing pivot	17 ft 10 in (5.44 m)		18 ft 5 in (5.61 m)	21 ft 10 in (6.65 m)
Loading height	11 ft 2 in (3.40 m)		11 ft 5 in (3.48 m)	13 ft 3 in (4.04 m)
Loading reach – dipper retracted	8 ft 9 in (2.67 m)		8 ft 8 in (2.64 m)	11 ft 6 in (3.50 m)
Swing arc	180°		180°	180°
Bucket rotation –				
#1 position	170°		170°	170°
#2 position	170°		170°	170°
Stabilizer spread – operating	9 ft 5 in (2.87 m)		9 ft 5 in (2.87 m)	9 ft 5 in (2.87 m)
Digging force –				
Bucket cylinder	11,212 lbf (49 873 N)		11,212 lbf (49 873 N)	11,212 lbf (49 873 N)
Dipper cylinder	7,049 lbf (31 356 N)		6,686 lbf (29 741 N)	4,884 lbf (21 725 N)
	w/bucket @ 46°		w/bucket @ 50°	w/bucket @ 55°
Leveling angle				
maximum slope that backhoe will make vertical cut	12°		12°	12°

## STANDARD EQUIPMENT

### OPERATOR'S COMPARTMENT

See page 2

### ENGINE

Case Family III 445/M2 diesel  
Tier II certified  
Automatic fan belt tensioner  
Integral engine oil cooling  
Fuel filter w/water trap  
Dual element air cleaner  
90 amp alternator  
850 CCA 12-volt battery  
Heavy-duty radiator w/deaeration bottle  
Spark-arresting muffler

### LOADER

See page 2

## OPTIONAL EQUIPMENT

### OPERATOR'S COMPARTMENT

Cab with –  
Heater  
Defroster  
Dome light - door activated w/switch  
Wipers, front and rear  
Tinted glass  
Floor mat  
Side window partial hold open  
Inside release for side windows  
Operator Convenience Package  
Tilt wheel  
Windshield washer w/adjustable nozzles (front & rear)  
Sun visor  
Deluxe Cab Package  
Operator Convenience Package  
PLUS  
Vinyl-covered interior  
Radio-ready kit w/antenna and speakers  
Reduced sound level to 72 dB(A)  
Vinyl or cloth-covered mechanical suspension seat  
Air Ride suspension seat  
3 in (76 mm) retractable seat belt  
Cab air-conditioning, 100% filtered air, in-cab filter access, 8 adjustable roof vents, 2 floor vents, w/heater

### BACKHOE

See page 2

### POWERTRAIN

2WD  
4F/4R Power shuttle synchromesh transmission  
Torque converter  
Transmission de-clutch  
Electro-hydraulic differential lock  
Hydrostatic steering  
Wet disc brakes

### HYDRAULICS

2-spool loader control valve  
6-spool backhoe control valve  
Heavy-duty oil cooler

### Ride Control

Cab, right door  
Canopy Convenience Package  
Front windshield w/wiper & washer  
85 dB(A) sound  
Floor mat  
Sun visor

### LOADER

Hydraulic front quick coupler  
Attachment auxiliary hydraulics  
3 spool valve hydraulics w/control  
Buckets (see page 2)

### BACKHOE

Case coupler  
Attachment auxiliary hydraulics  
Extendahoe®  
Two-lever control  
Joystick Actuated Pilot Operated Control System  
Fingertip Proportional  
Electrohydraulic stabilizer controls.  
Thumb operated Proportional  
Electrohydraulic Extendahoe control  
Thumb operated horn button  
Thumb operated AuxiliaryHydraulic Control  
Infinitely Adjustable Towers  
In-Cab Switchable "Excavator to Backhoe" control pattern change

### OTHER

Forward tilt engine hood  
Replaceable, molded front bumpers  
Front/rear tie downs  
Reflective logos  
Lights - Cab and Canopy  
(2) Rear tail/stop  
(2) Front flashers/turn  
(2) Rear flashers/turn  
Cab only  
4 Front & 4 rear adjustable halogen lights (55 w)  
Canopy only  
2 Front & 2 rear adjustable halogen lights (55 w)

### Stabilizer pads

Flip-over  
Rubber pad

### Front counterweights

440 lb (200 kg)  
900 lb (408 kg)

### ENGINE

Cold weather grid heater starting aid  
Dual, 12-volt, 600CCA batteries  
Fuel tank, 40 gal (151 L)  
Exhaust aspirated air cleaner

### POWERTRAIN

4WD w/outboard planetary drive, on-the-go push-button activation and 12 x 16.5 front tires

### HYDRAULICS

Auxiliary backhoe uni-directional hydraulics  
Auxiliary backhoe bi-directional hydraulics

### OTHER

Outside breakaway mirror  
17.5L x 24 rear tires  
19.5L x 24 rear tires  
Tool box  
Special paint  
Lights - canopy  
Additional 2 front and 2 rear halogen lights (55 w)

NOTE: All specifications are stated in accordance with SAE Standards or Recommended Practices, where applicable.

NOTE: All engines meet current EPA emissions requirements.

IMPORTANT: CNH America LLC reserves the right to change these specifications without notice and without incurring any obligation relating to such change. CNH America LLC does not warrant the safety or reliability of attachments from other manufacturers.

Case is a registered trademark of CNH America LLC. Any trademarks referred to herein, in association with goods and/or services of companies other than CNH America LLC, are the property of those respective companies.



[www.casece.com](http://www.casece.com)

 CASE IS A BRAND OF CNH,  
A GLOBAL LEADER IN CONSTRUCTION EQUIPMENT, AGRICULTURAL EQUIPMENT AND FINANCIAL SERVICES.

Form No. CCE1200502  
Same information as form no. CCE4070434

Printed in U.S.A.

© 2005 CNH America LLC  
All Rights Reserved